



Board of Education
Meeting Materials Cover Sheet April 24, 2018

A. High School Education Specification – Area Program Comparison

This document identifies the recommendation and optional program spaces in the current high school education specification as well as recent high school projects.

B. Area Program Notes

Each project uniquely conforms to the high school education specification to adjust for site constraints, existing conditions, school programming needs, etc. This document provides some notes as to how each site adjusted to fit the needs of the school.

C. Area Program Comparison Summary

A simplified version of the Area Program Comparison focusing on the current high school education specification, two Madison High School design options and the current Lincoln High School master plan.

D. ED Spec Comparison for Design Options

This document provides a quick “snap shot” view of how the Madison High School and Lincoln High School plans conform to the education specifications in both a qualitative format.

E. Cost Reduction Options

Both the Madison High School and Lincoln High School project teams have reviewed some potential cost reductions options. Please note: these options are not recommendations from the team, rather they are options that have been explored.

- Cost Reduction Options – Lincoln High School
- Cost Reduction Options – Madison High School

F. Presentation Materials

In an effort to provide additional project detail and background attached are the following recent presentation materials:

- Lincoln High School: Design Advisory Group Presentation (March 8, 2018)
- Madison High School: Steering Committee Presentation (April 23, 2018)

Ed Spec Comparison for Design Options

	Madison High School Total Project Budget = \$146M		Lincoln Budget = \$187M	Grant	Franklin
	Option A \$185.0M 289,185 SF	Option B \$172.0M 281,560 SF	Option A \$218M 281,000 SF	293,360 SF	282,802 SF
Ed Spec Guiding Principles	+ \$39.0M	+ \$26.0M	+ \$31.0M		
<i>School "Heart"</i> - Schools should have a recognizable center	✓	✓	✓	✓-	✓
<i>Viewable</i> - School should feel open and accessible	✓	✓	✓	✓	✓
<i>Learning Suite</i> - Classrooms should be grouped around a shared commons	✓	✓-	✓	✓-	✓
<i>Transparency</i> - Spaces should be transparent to support security, and interaction	✓	✓	✓	✓	✓
<i>Variety</i> - Spaces should be designed to support a variety of groups	✓	✓	✓	✓	✓-
<i>Flexible/Agile</i> - Rooms should be designed to expand and contract	✓	✓-	✓	✓-	✓-
<i>Entry</i> - The school should have a strong identifiable main entry	✓	✓	✓	✓	✓
<i>"A School Should"</i> - A school should feel warm, inviting and comfortable	✓	✓	✓	✓	✓
<i>Natural Light</i> - A school should be filled with light	✓	✓	✓	✓	✓
<i>Acoustics</i> - Account for the variety of sounds and levels created in a school environment	✓	✓	✓	✓	✓
<i>Capacity</i> - Accommodates up to 1700 students	✓	✓-	✓	✓	✓
Ed Spec Program Spaces					
41 Classrooms @ 980 SF	✓ -	✓ -	✓	✓	✓ -
11 Science Labs @ 1500 SF	✓ -	✓ -	✓	✓ -	✓ -
Teacher Collaboration / Flex Spaces	✓ -	✓ -	✓	✓	✓
Auxiliary Gym	✓	✓	✓	✓	✓
HVAC, ADA, Seismic, & safety Upgrades	✓	✓	✓	✓	✓ -
Athletic Fields / Stadium	✓	✗	✗	✓ -	✓
Fine and Performing Arts	✓	✓	✓	✓	✓



Meets or exceed Ed Spec



Partially meets Ed Spec



Does not meet Ed Spec

LINCOLN HIGH SCHOOL

Design Advisory Group Meeting Two

March 8, 2018



**Select slides frm the March 8th, DAG meeting.

Master Planning Evaluation Criteria

PREREQUISITE 1: MEETS THE MPC VISION STATEMENT



- Center of urban community
- Promotes school as a catalyst for the neighborhood

PREREQUISITE 2: MEETS CITY REQUIREMENTS

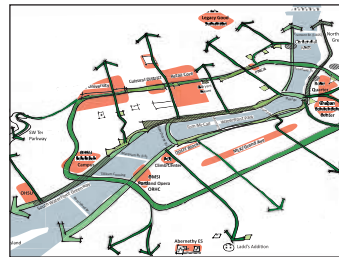

- Pedestrian and bicycle connections through the site
- Open/green space
- Robust street presence per Central City Guidelines
- Neighborhood engaged in the design process
- Covered parking (upcoming Central City Plan revisions)

CRITERION 1: SUPPORTS THE ED SPECS



- Educational Specifications will be accommodated
- Optimal configuration to support active learning

CRITERION 2: FITS THE SITE



- The athletic program includes track and field areas
- Usable outdoor space for students, staff and community
- 100 parking places on site

CRITERION 3: ACTIVE CONNECTED AND SAFE SITE DESIGN



- Front door visible from SW Salmon Street
- Pedestrian connectivity through the site
- Layout provides safety and security
- Active ground floor uses and street edges per Central City guidelines
- Resiliency: Provide Category 4 Seismic Performance in the gymnasium

CRITERION 4: IMPROVES OFF-SITE CONDITIONS



- Safer pedestrian crossings
- Improved student and visitor drop-off experience
- Safe access for service vehicles
- Safe and convenient bus access

CRITERION 5: FITS THE BUDGET



- Provides best long term value for the District
- Is affordable within the anticipated Bond capacity
- Minimizes long-term operational costs

CRITERION 6: MEETS SCHEDULE



- Can be completed within the required time frame
- Can safely provide temporary swing facilities on site
- Minimizes impact on teaching and learning during the construction period

SITE DESIGN

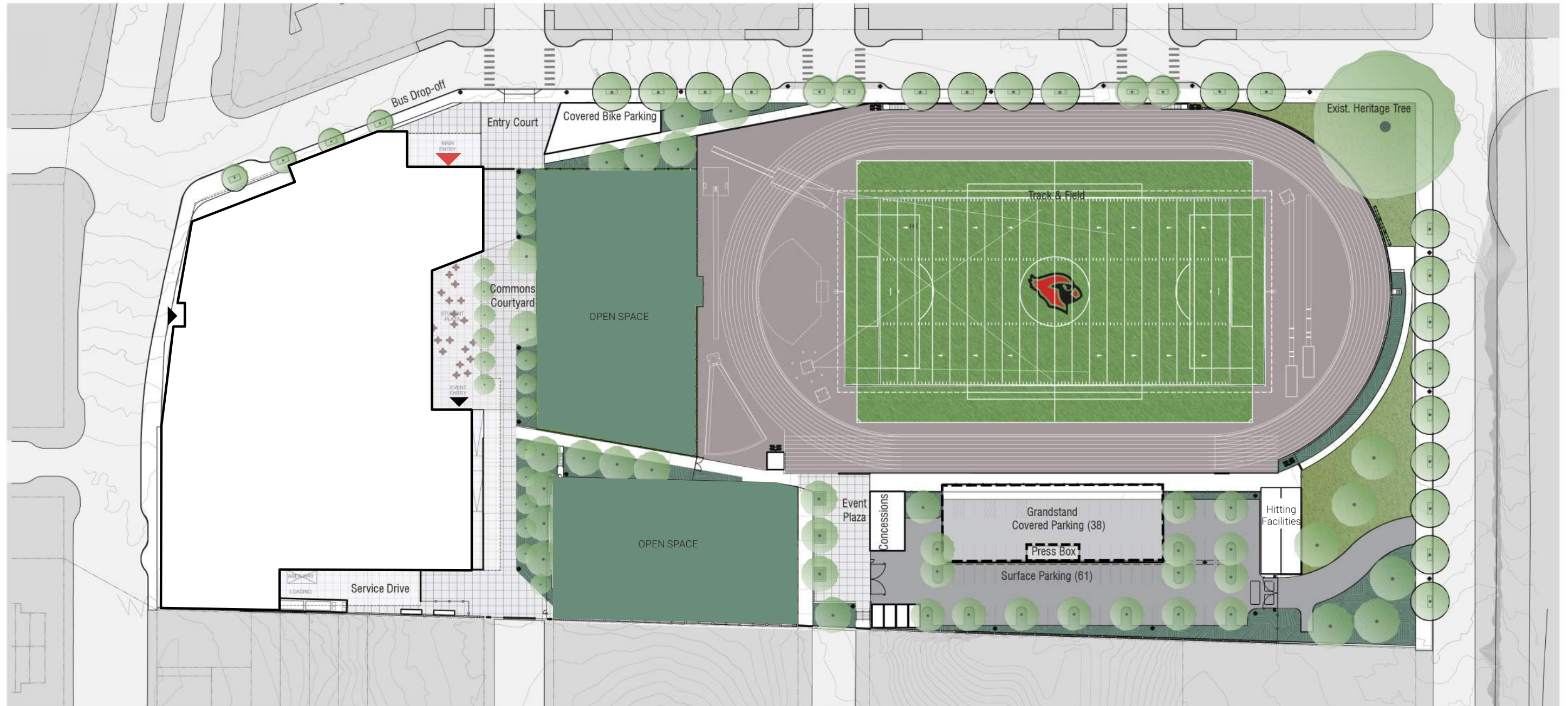

AERIAL VIEW From South East

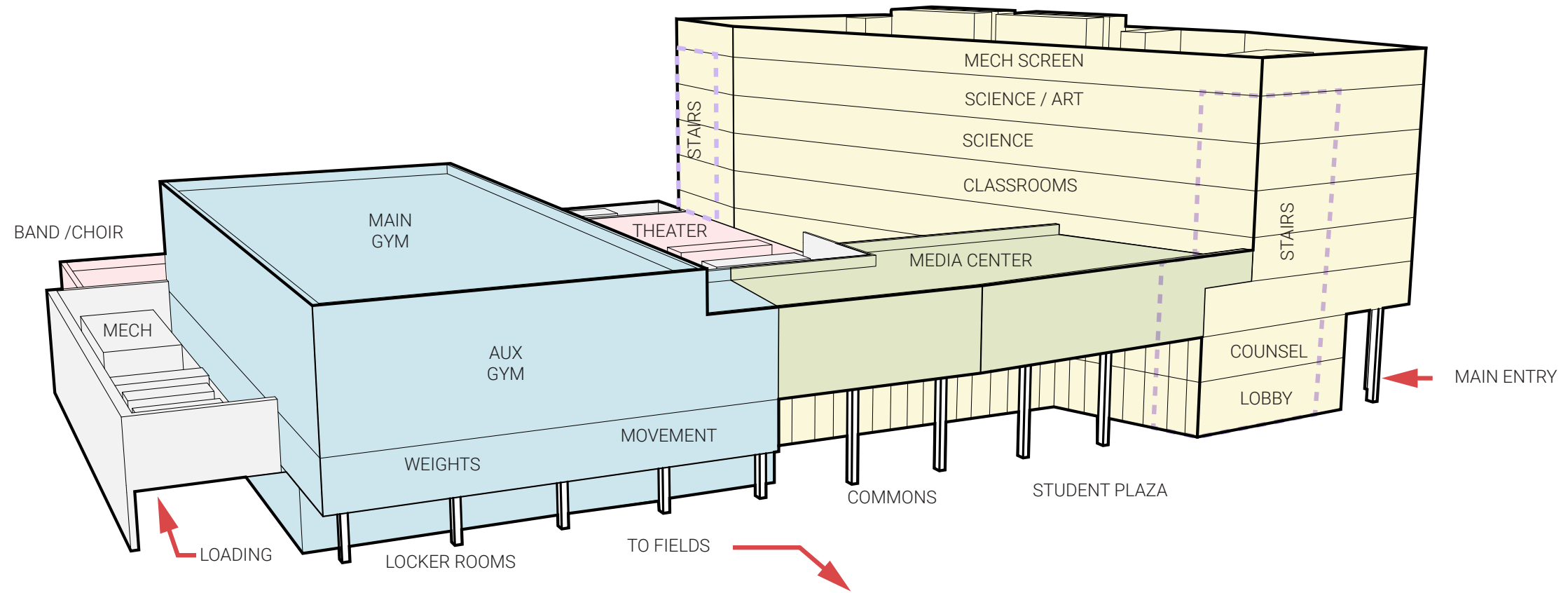

FLOOR PLAN DIAGRAMS Ground Floor

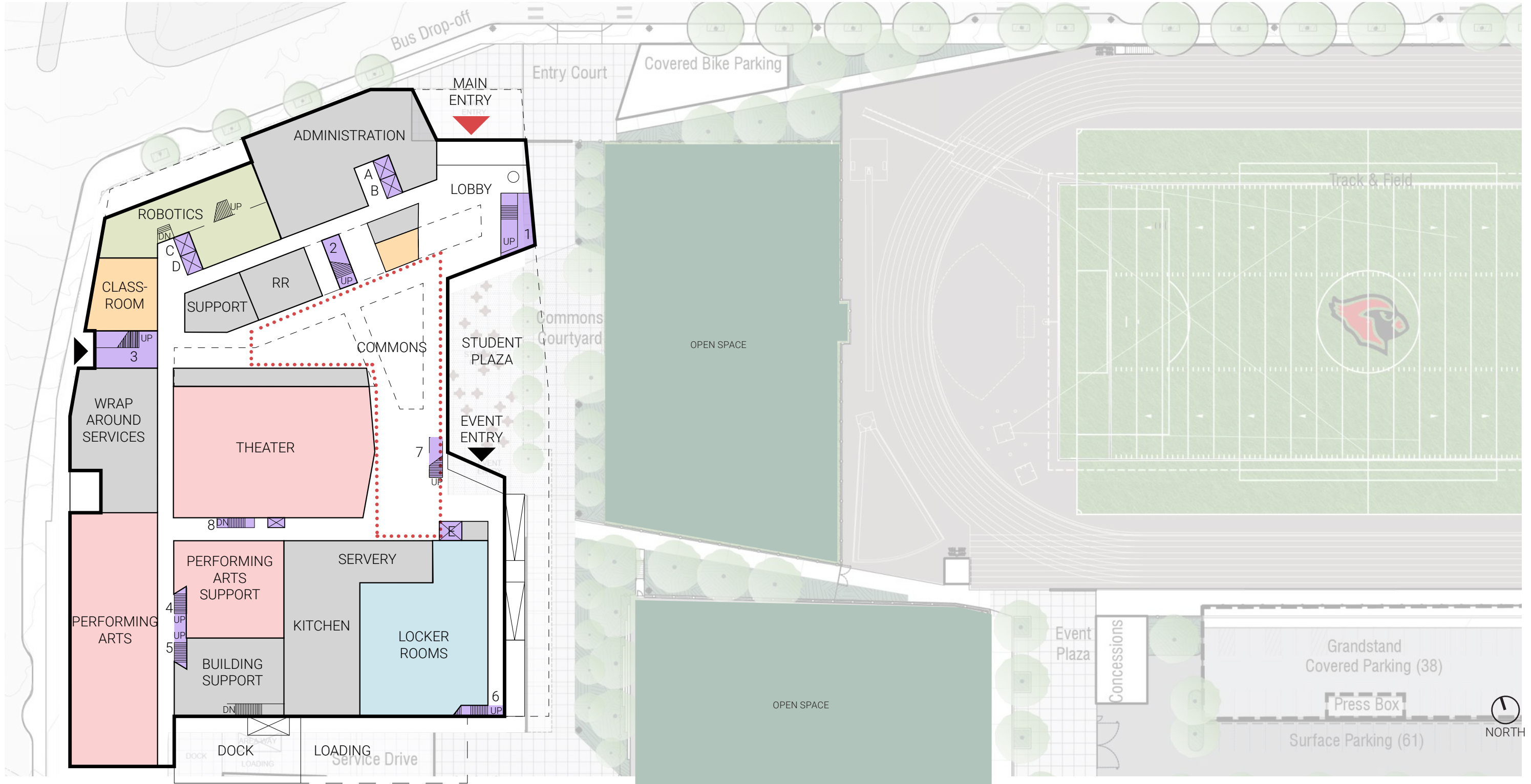

FLOOR PLAN DIAGRAMS

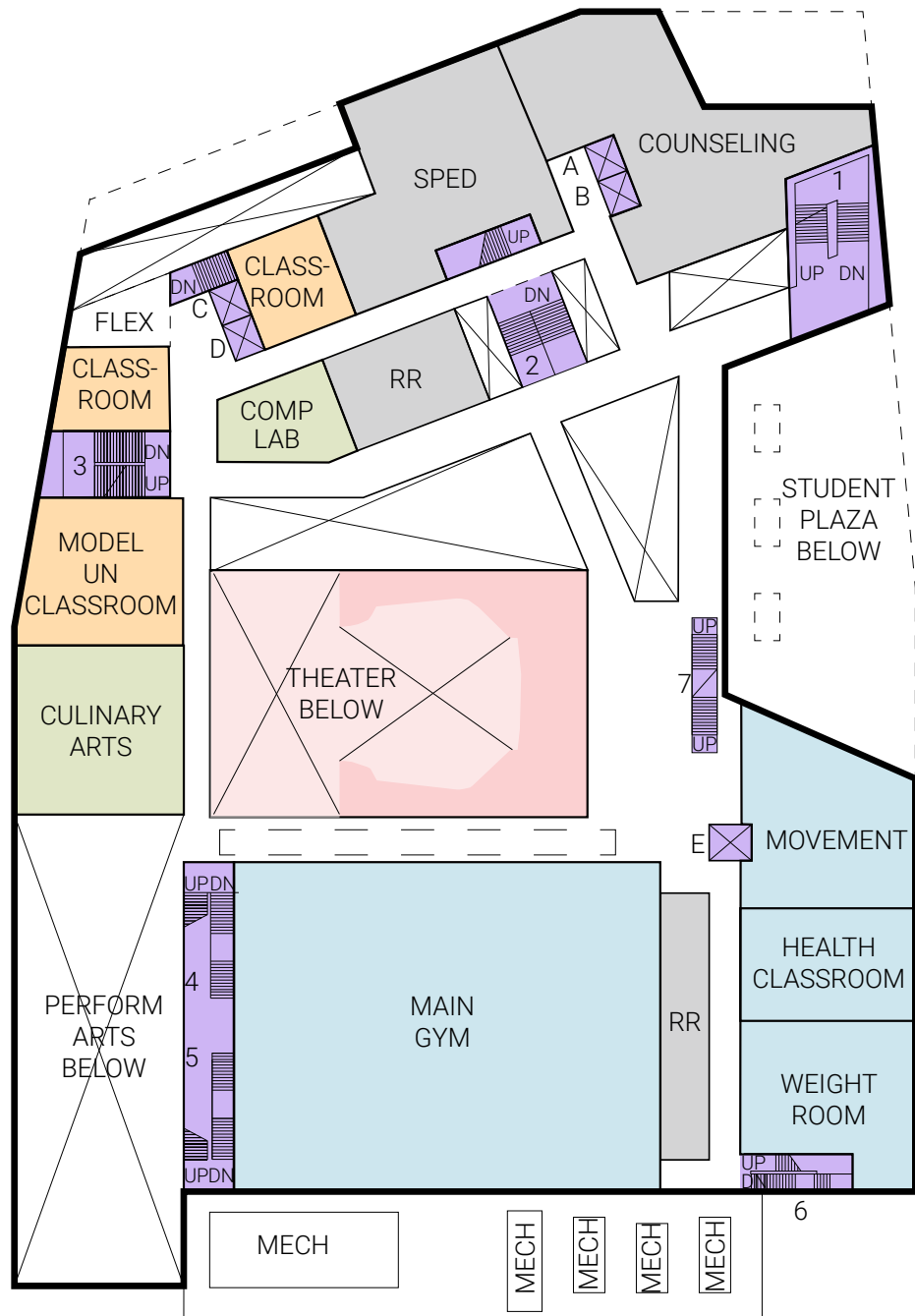

Second Floor

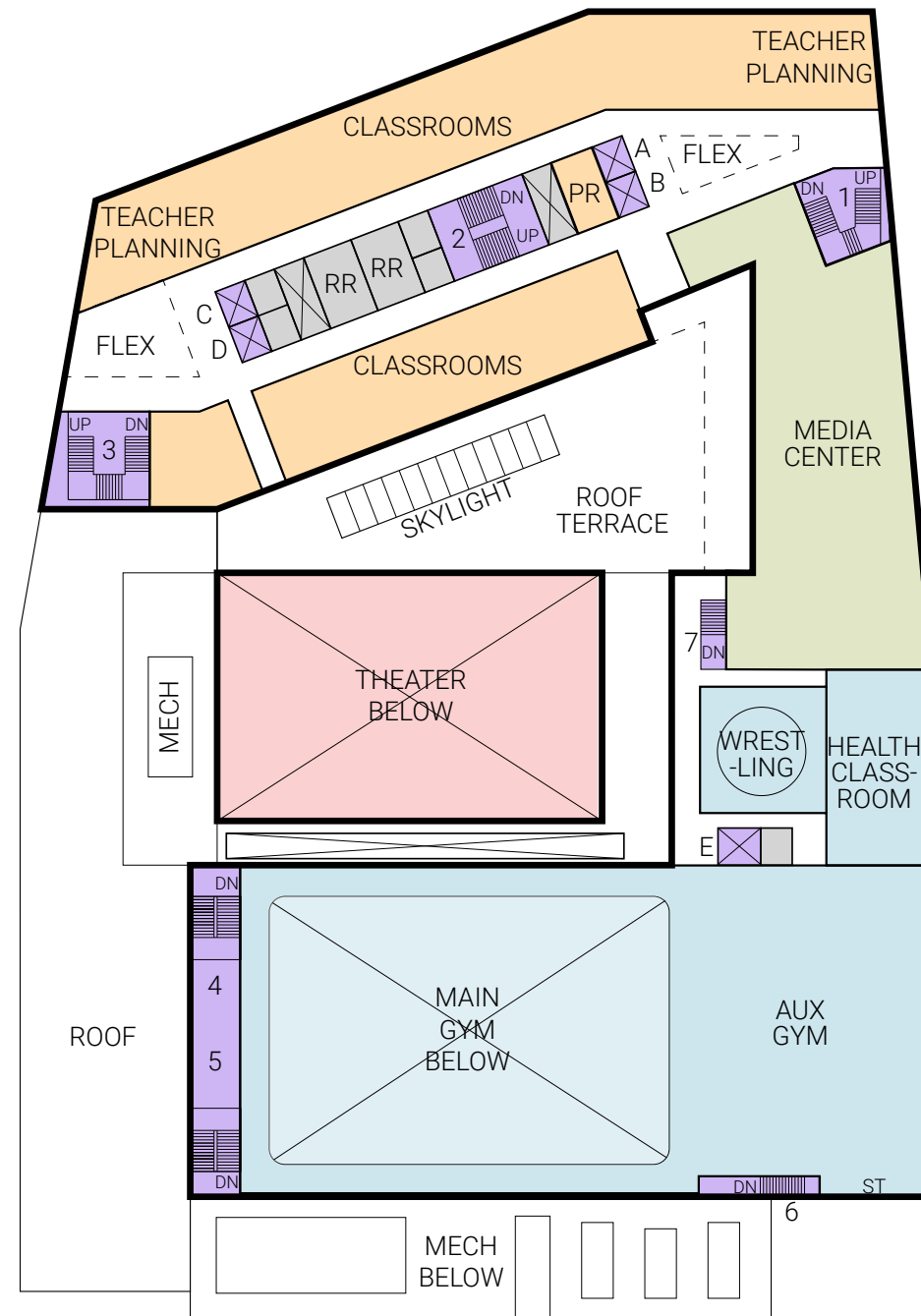

Third Floor



NORTH

FLOOR PLAN DIAGRAMS

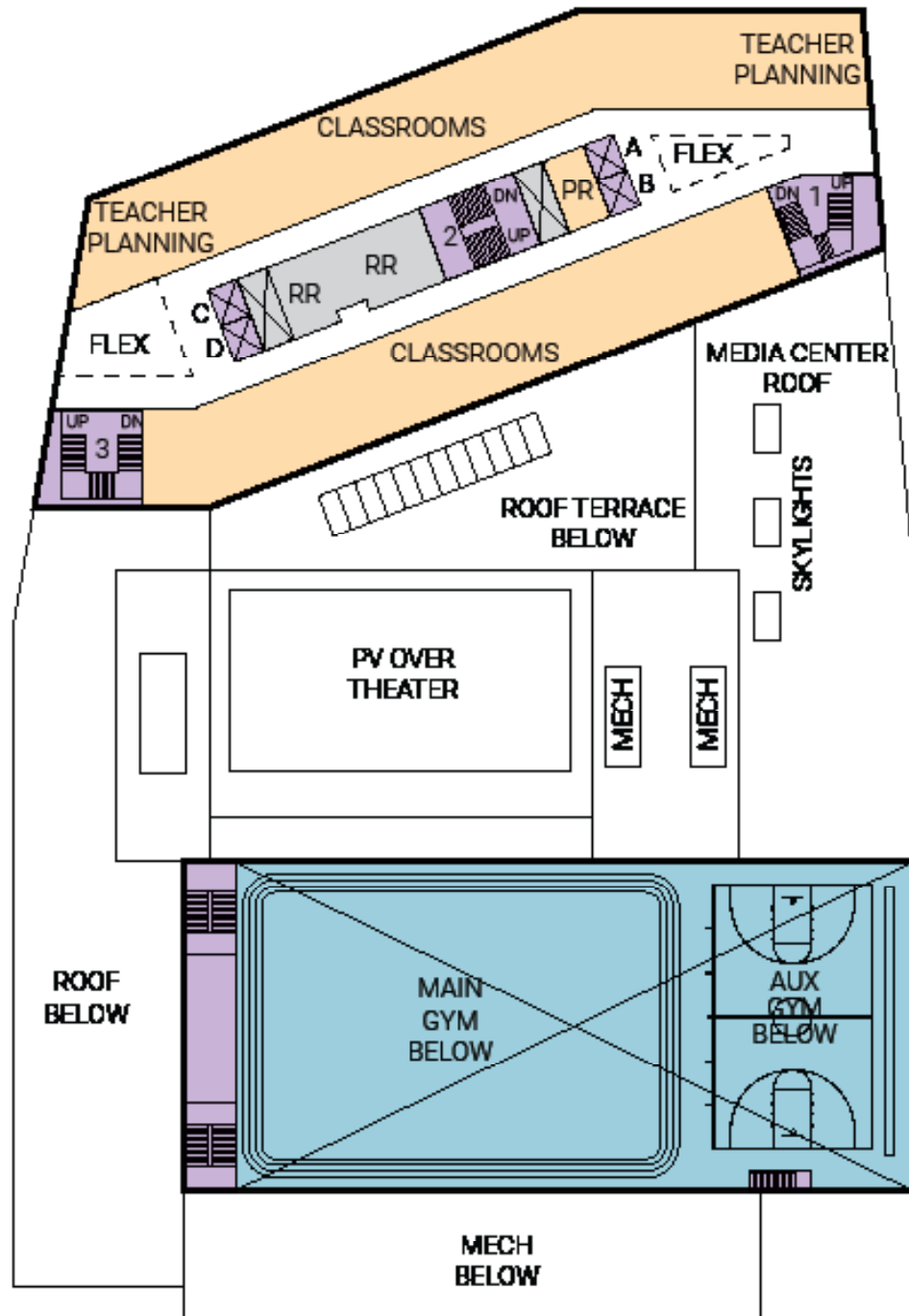

Fourth Floor

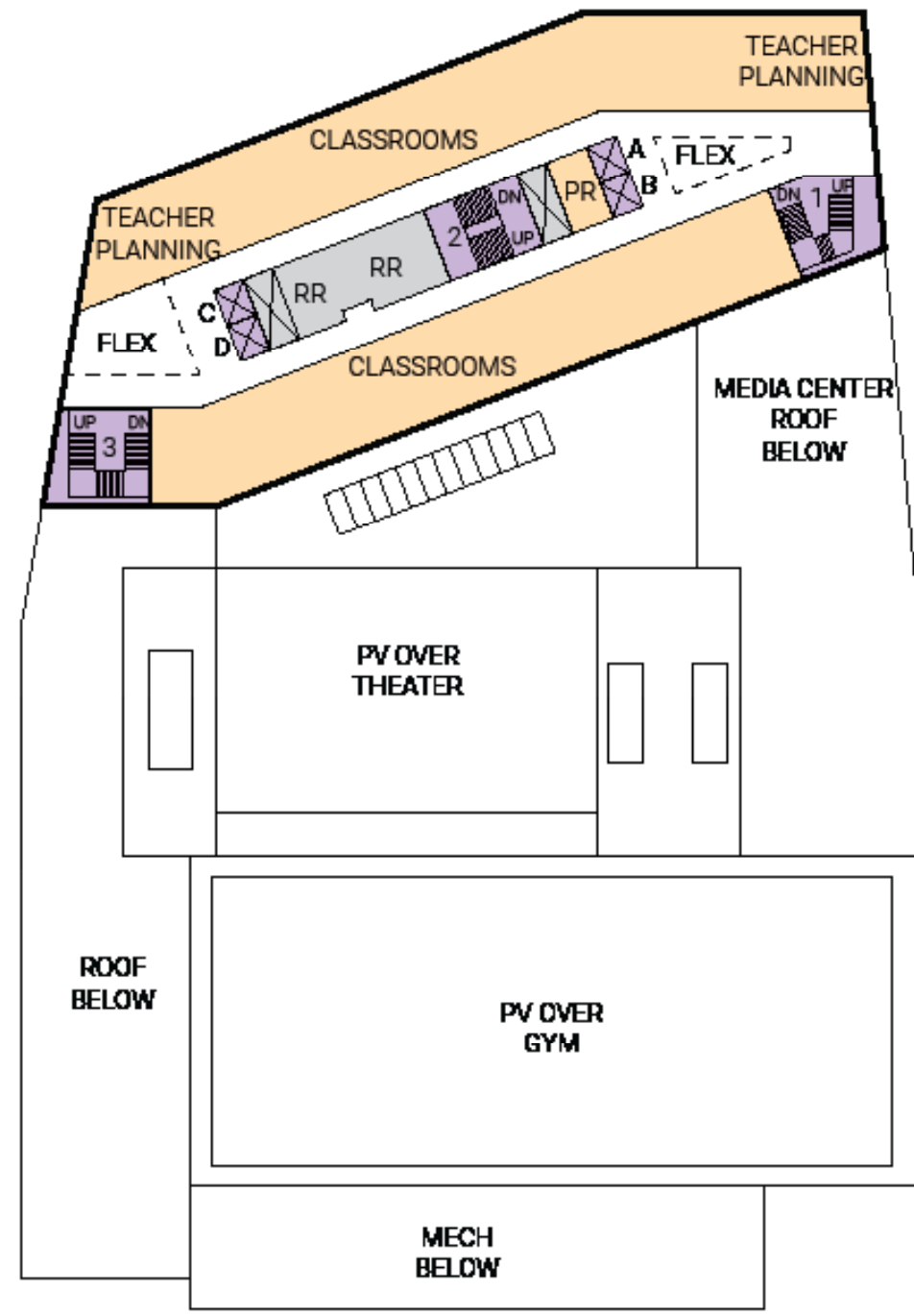

Fifth Floor



NORTH

FLOOR PLAN DIAGRAMS

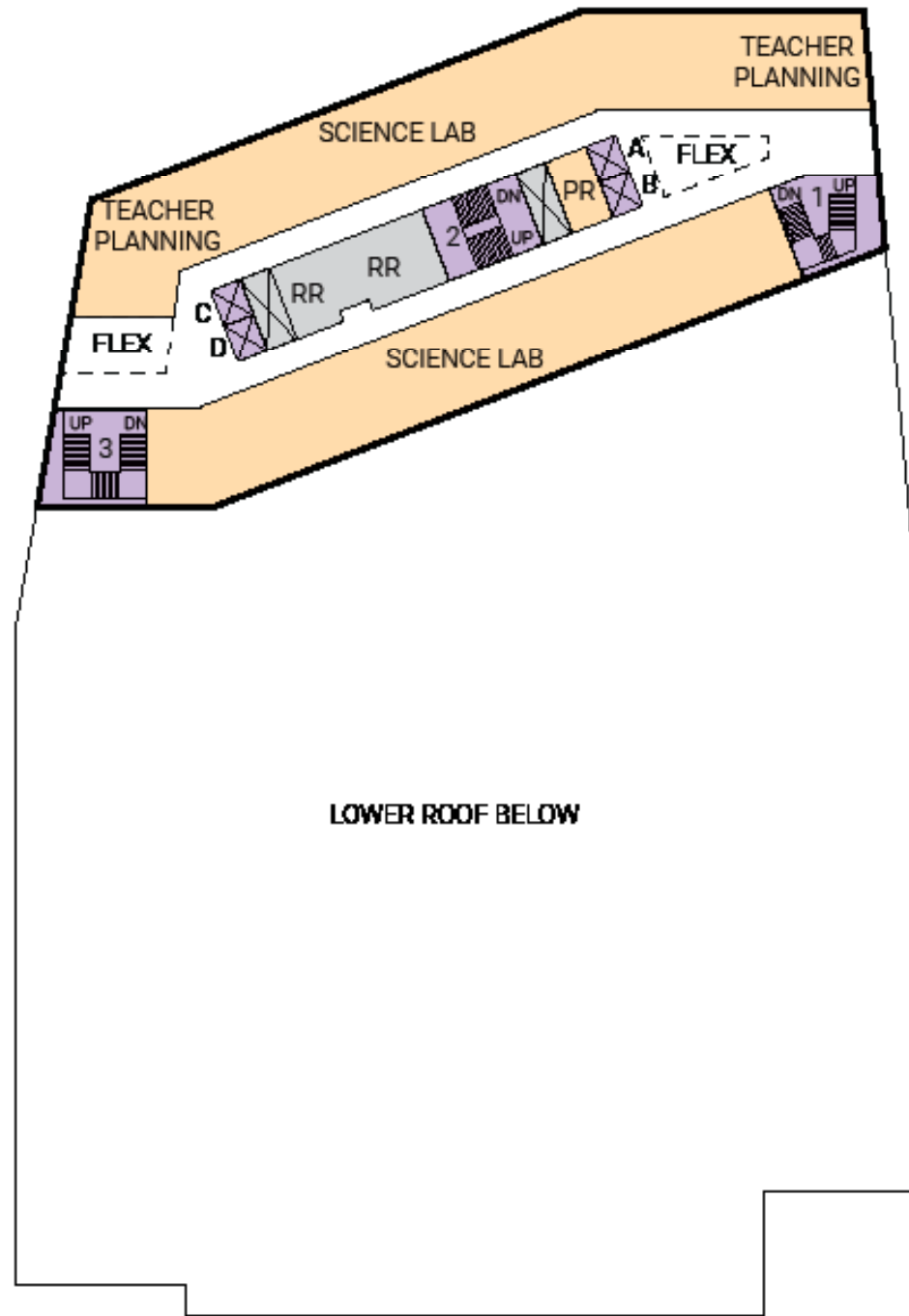

Sixth Floor

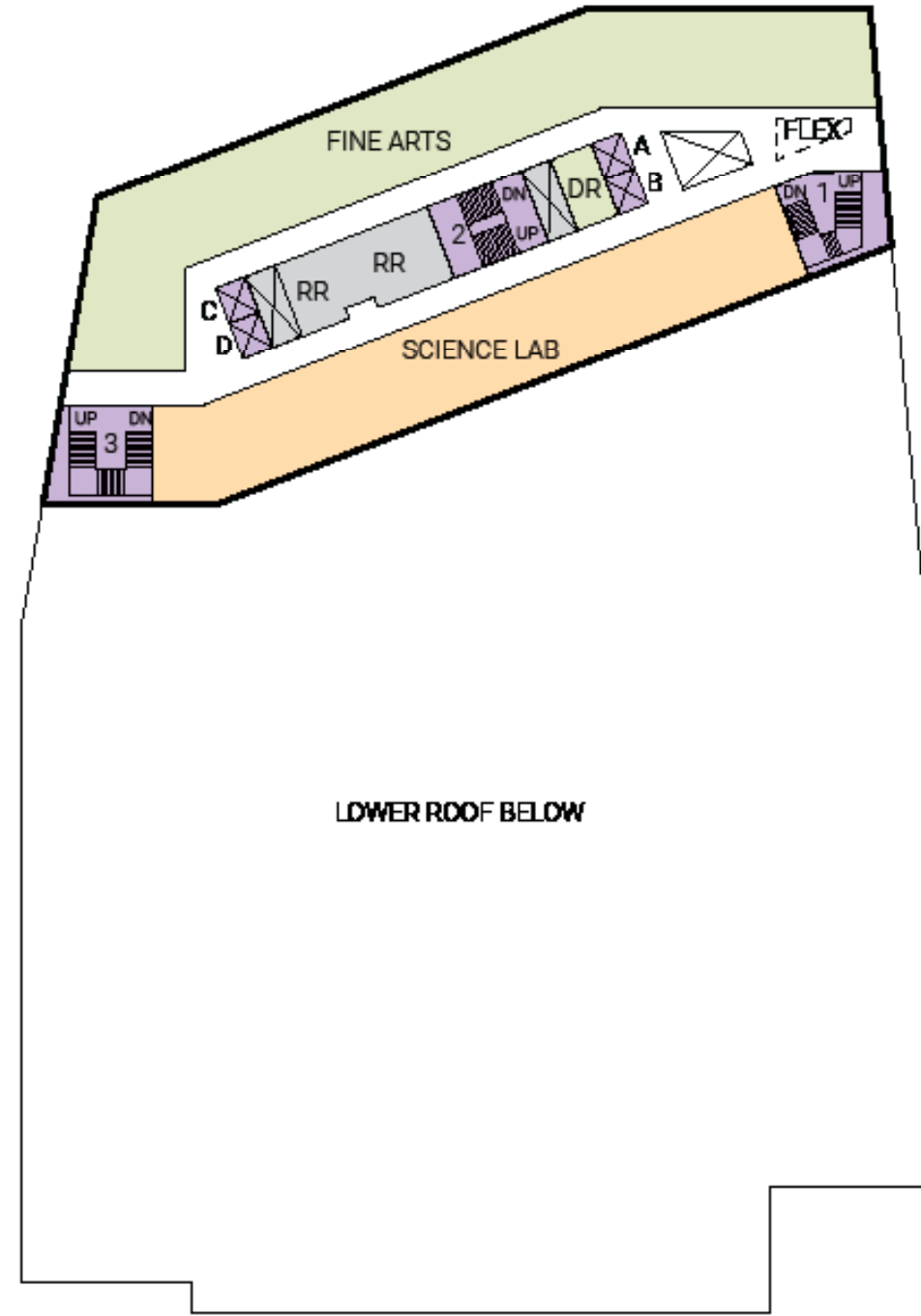

Seventh Floor



PROPOSED BUILDING SECTION

North-South Section - looking west

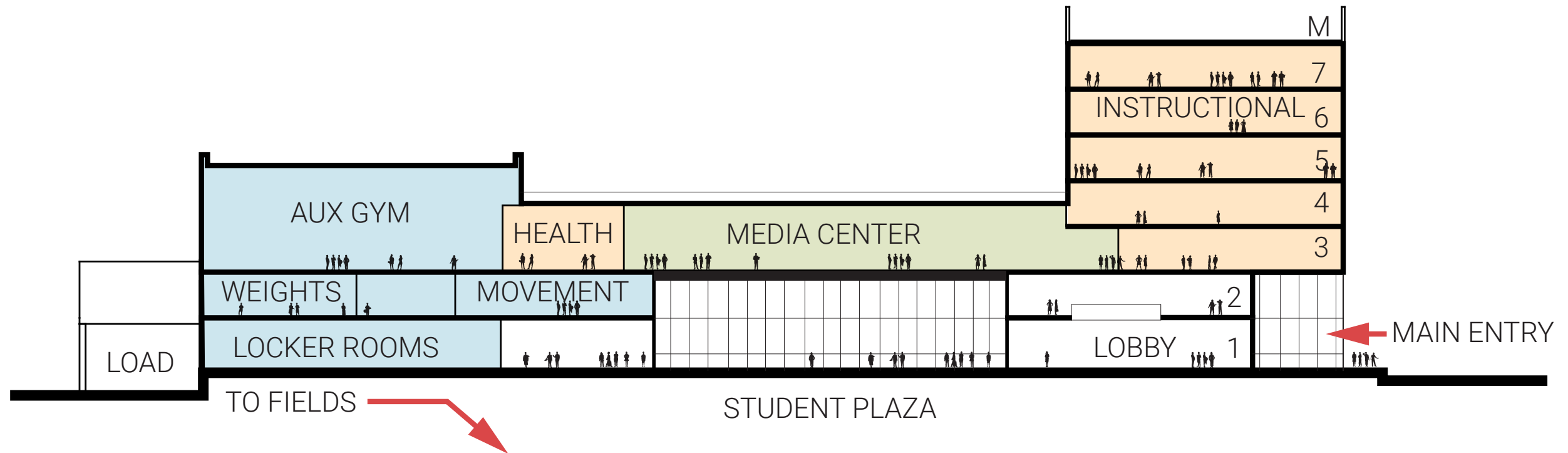

MADISON HIGH SCHOOL REVISED MASTER PLAN

STEERING COMMITTEE

MARCH 12 2018

OVERALL SITE PLAN



opsis + dao

